



10/519-525 Dean Street Albury NSW

Prominently positioned within the City Walk Arcade, this premises provides a retail or office opportunity with profile shopfront, timber flooring and kitchenette.

Area approximately 67 square metres.

City Walk Arcade is located on Albury's main retail ant track amongst national occupiers. It is centrally positioned between Albury's main shopping centres - Myer Centrepoint and West End Plaza.

Opposite the Art Centre 'MAMA' and QEII square, City Walk Arcade offers modern amenities, energy efficient lighting and heating and cooling throughout with easy access from Dean Street and Volt Lane car park which has over 500 car parks.

Price : Contact Agent
Building Size : 67 sqm
View : <https://www.dixoncre.au/lease/nsw/murray-region/albury/commercial/retail/7613641>



Chris Brown
02 6055 0000

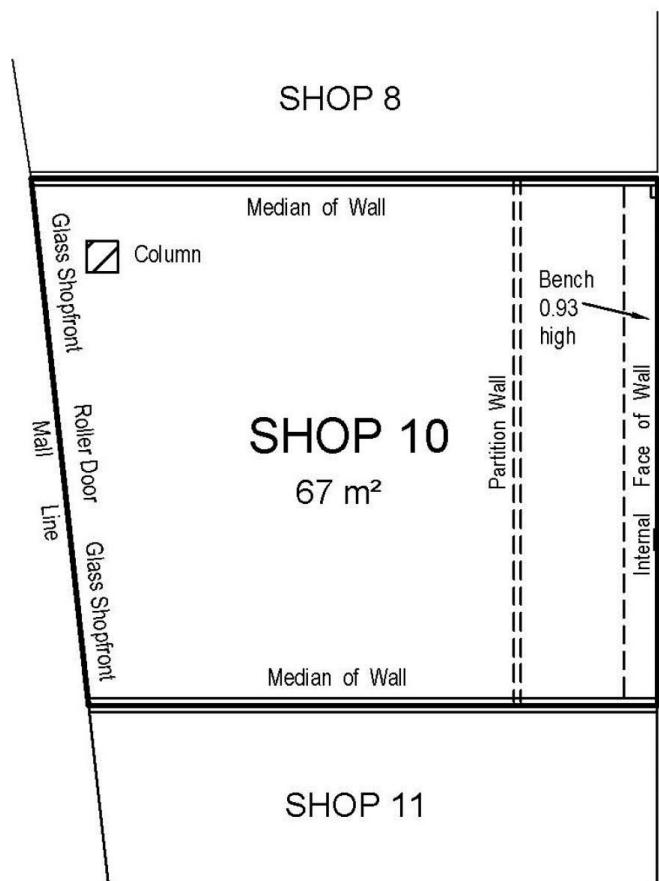

Notations

Date of survey : 6th March 2013
 Area shown has been calculated using
 the guidelines in the Property Council
 of Australia
 Guide (March 1997)
 'Method of Measurement for Lettable
 Area'
 Method used : GLAR - Gross Lettable
 Area - Retail

Lease Area Plan
Shop 10
City Walk Arcade
519-525 Dean Street Albury

Scale A4

1 : 100

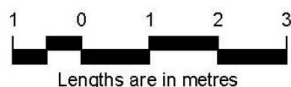

Co-ordinate Datum	Local	Sheet	1	of	1
Drawing No.	139016SV00	Version	1		
CAD Ref.	F:\13\139016\139016SV00				
Drawn By	ES	Checked By	JRH	Date	11/3/2013

spiire
 Innovation in
 Infrastructure

445 Townsend Street
 PO Box 3400
 Albury NSW 2640
 T 61 2 6051 1300
 spiire.com.au