



11/519-525 Dean Street Albury NSW

Currently fitted out with an office and kitchenette, this is an affordable opportunity for an office occupant looking to start up or expand.

Area of approximately 40 square metres.

City Walk Arcade is located on Albury's main retail ant track amongst national occupiers. It is centrally positioned between Albury's main shopping centres - Myer Centrepoint and West End Plaza.

Opposite the Art Centre 'MAMA' and QEII square, City Walk Arcade offers modern amenities, energy efficient lighting and heating and cooling throughout with easy access from Dean Street and Volt Lane car park which has over 500 car parks.

Price : Contact Agent
Building Size : 40 sqm
View : <https://www.dixoncre.au/lease/nsw/murray-region/albury/commercial/retail/6256277>



Chris Brown
02 6055 0000



MALL

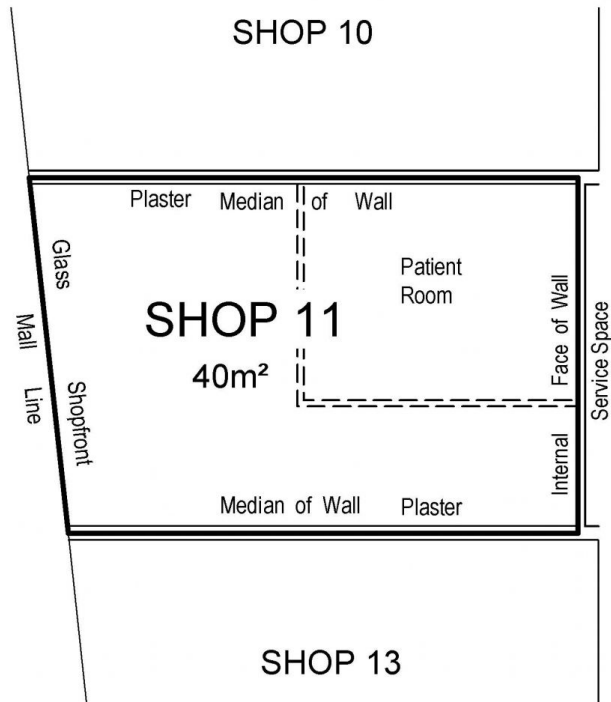

Notations

Date of survey : 6th March 2013
Area shown has been calculated using
the guideLines in the Property Council
of Australia
Guide (March 1997)
'Method of Measurement for Lettable
Area'
Method used : GLAR - Gross Lettable
Area - Retail

Lease Area Plan
Shop 11
City Walk Arcade
519-525 Dean Street Albury

Scale A4
1 : 100

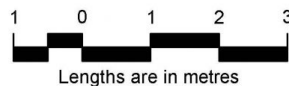

Co-ordinate Datum	Local	Sheet	1	of	1
Drawing No.	139016SV00	Version	1		
CAD Ref.	F:\13\139016\139016SV00				
Drawn By	ES	Checked By	JRH	Date	11/3/2013

spiire
Innovation in
Infrastructure

445 Townsend Street
PO Box 3400
Albury NSW 2640
T 61 2 6051 1300
spiire.com.au