



**482 Kiewa Street Albury NSW**

- Site area 2,340sqm (approx.)
- Zoning B3 - Commercial Core under LEP 2010
- Conceptual plans available for major retail development
- Superbly located
- Adjacent to the Volt Lane Development
- Unique opportunity

**Land Size** : 2340 sqm  
**View** : <https://www.dixoncre.au/sale/nsw/murray-region/albury/commercial/development/5851264>

DEAN (ALIGNED 503-20115-503) STREET



STREET

(ALIGNED 503-20115-503)

KIEWA

APFD  
NEED AS LAD  
NEED AS LAD

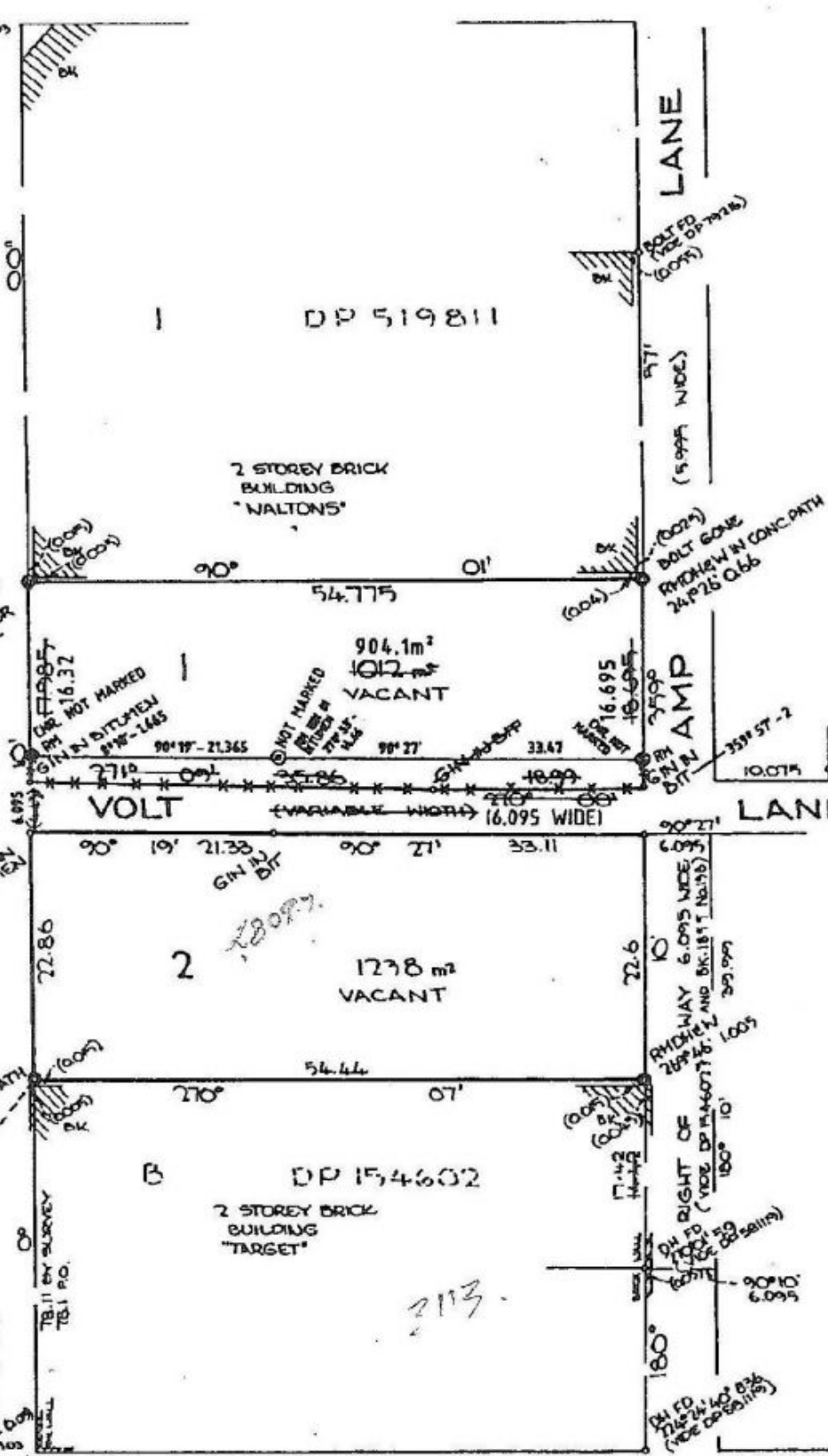

SMOLLETT (ALIGNED 505-20115-503) STREET

D.P. 607859