

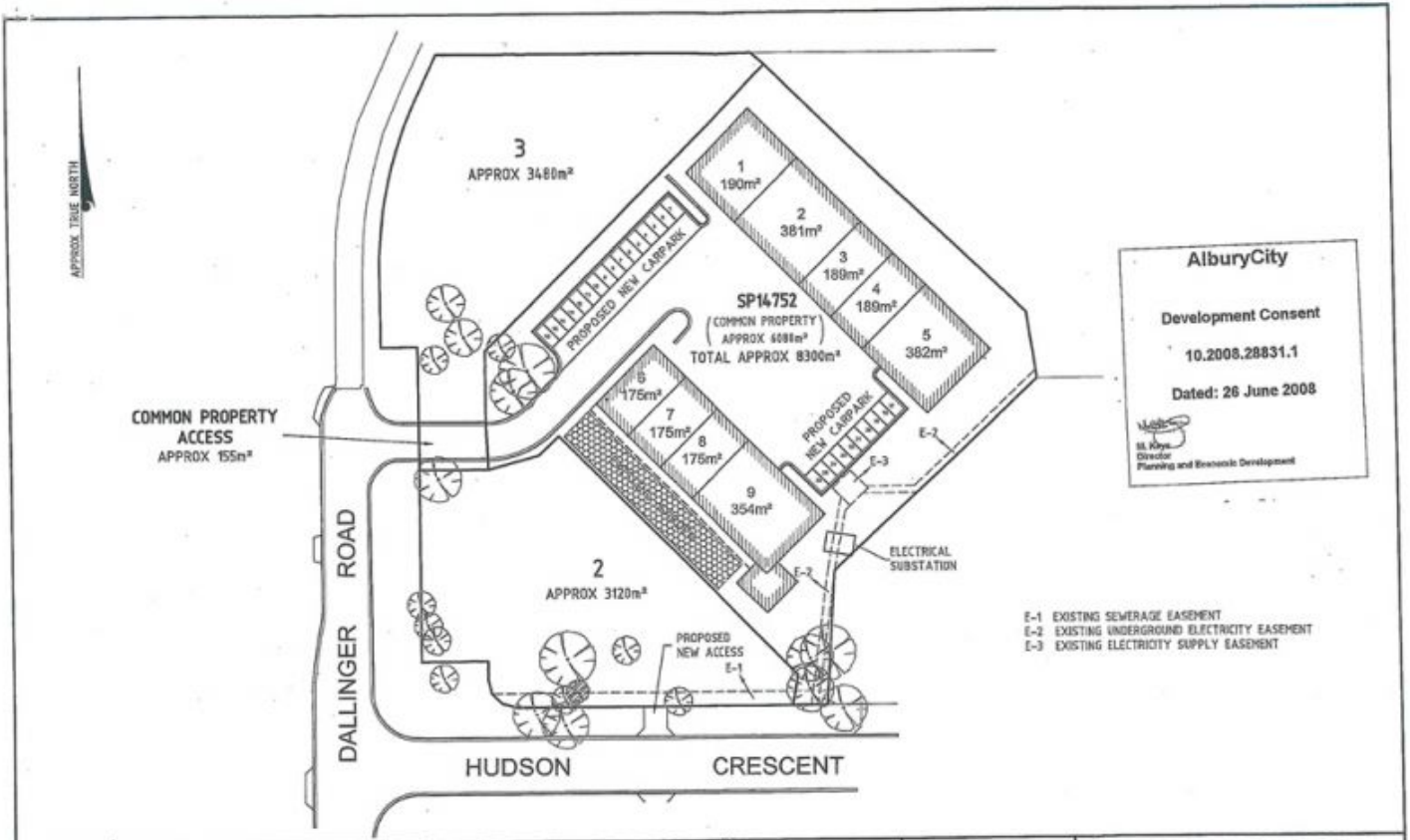

B4/10 Hudson Crescent Lavington NSW

- Comprising approx. 189m²
- Well established Tenant
- Current rent \$10,978 per annum plus GST
- Lease expiring 31st March 2013

Building Size : 189 sqm
View : <https://www.dixoncre.au/sale/nsw/murra-y-region/lavington/commercial/industrial/5851251>



AlburyCity

Development Consent
10.2008.28831.1
Dated: 26 June 2008

St. Kevs
St. Kevs
Director
Planning and Economic Development

E-1 EXISTING SEWERAGE EASEMENT
E-2 EXISTING UNDERGROUND ELECTRICITY EASEMENT
E-3 EXISTING ELECTRICITY SUPPLY EASEMENT

NOTE:
Areas, dimensions and lot layout are approximate only and are subject to final survey, council approval and registration of the Plan of Subdivision at the Titles Office

edm
EDM Group
PLANNERS SURVEYORS & ENGINEERS

COPYRIGHT
THIS DOCUMENT REMAINS THE PROPERTY OF EDM GROUP AND IS ONLY TO BE USED FOR ITS INTENDED PURPOSE IN ACCORDANCE WITH THE TERMS OF THAT AGREEMENT.
UNAUTHORIZED USE OF THIS DOCUMENT IN ANY FORM WHATSOEVER IS PROHIBITED.
© EDM Group

EDM Group
PLANNERS SURVEYORS & ENGINEERS
OFFICES 99 HUME ST
PO Box 317, WODONGA 3689
Ph (02) 6024 2266
Fax (02) 6056 2392
EDM Group Pty Ltd
www.edmgroup.com.au

DESIGN RESPONSE

LOT 11 DP837414 AND SP14752
HUDSON CRESCENT
LAVINGTON 2640

Drawing No. 080024-ODP-8 Date 06/05/08 Sheet 1 of 1 A3

Scale 1:750