

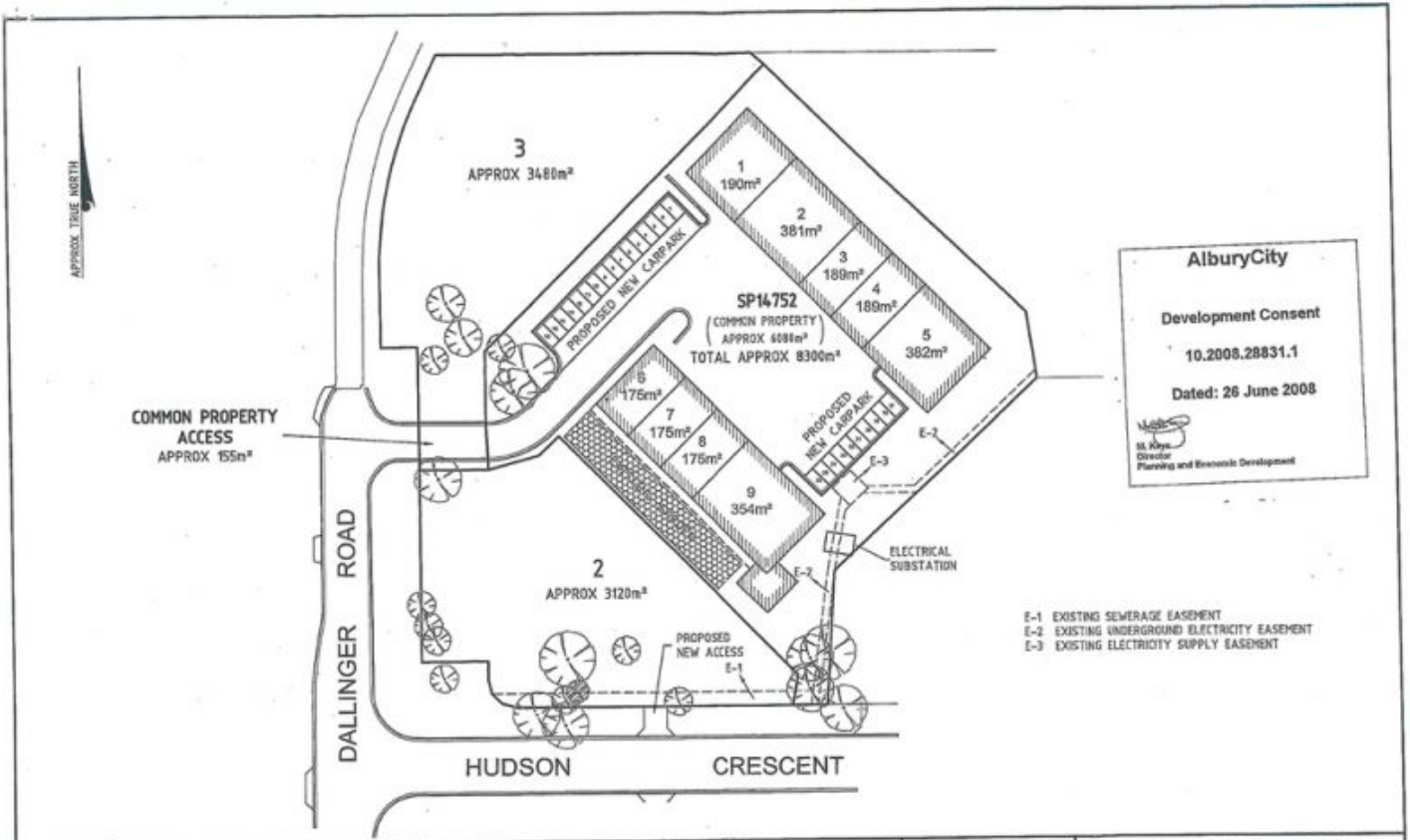

### **B3/10 Hudson Crescent Lavington NSW**

- Comprising approx. 189m<sup>2</sup>
- Currently leased
- Rental \$9,540 per annum plus GST, Rates and Water
- Own amenities
- High clearance access

**Building Size** : 189 sqm  
**View** : <https://www.dixoncre.au/sale/nsw/murra-y-region/lavington/commercial/industrial/5851250>



**AlburyCity**  
 Development Consent  
 10.2008.28831.1  
 Dated: 26 June 2008  
 M. Kope  
 Director  
 Planning and Economic Development

E-1 EXISTING SEWERAGE EASEMENT  
 E-2 EXISTING UNDERGROUND ELECTRICITY EASEMENT  
 E-3 EXISTING ELECTRICITY SUPPLY EASEMENT

**NOTE:**  
 Areas, dimensions and lot layout are approximate only and are subject to final survey, council approval and registration of the Plan of Subdivision at the Titles Office

**edm**  
 Copyright  
 THIS DOCUMENT REMAINS THE PROPERTY OF EDM GROUP AND IS ONLY TO BE USED FOR ITS COMMISSIONED PURPOSE IN ACCORDANCE WITH THE TERMS OF THAT COMMISSION.  
 UNAUTHORIZED USE OF THIS DOCUMENT IN ANY FORM WHATSOEVER IS PROHIBITED.  
 © EDM Group

**EDM Group**  
 PLANNERS SURVEYORS & ENGINEERS  
 OFFICES 99 HUME ST  
 PO Box 317, WODONGA 3689  
 Ph (02) 6024 2266  
 Fax (02) 6056 2392  
 EDM Group ABN 12 022 361 714  
 www.edmgroup.com.au

**DESIGN RESPONSE**  
 LOT 11 DP837414 AND SP14752  
 HUDSON CRESCENT  
 LAVINGTON 2640  
 Drawing No. 080024-ODP-8 Date 06/05/08  
 Scale 1:750  
 SHEET 1 OF 1  
 A3