

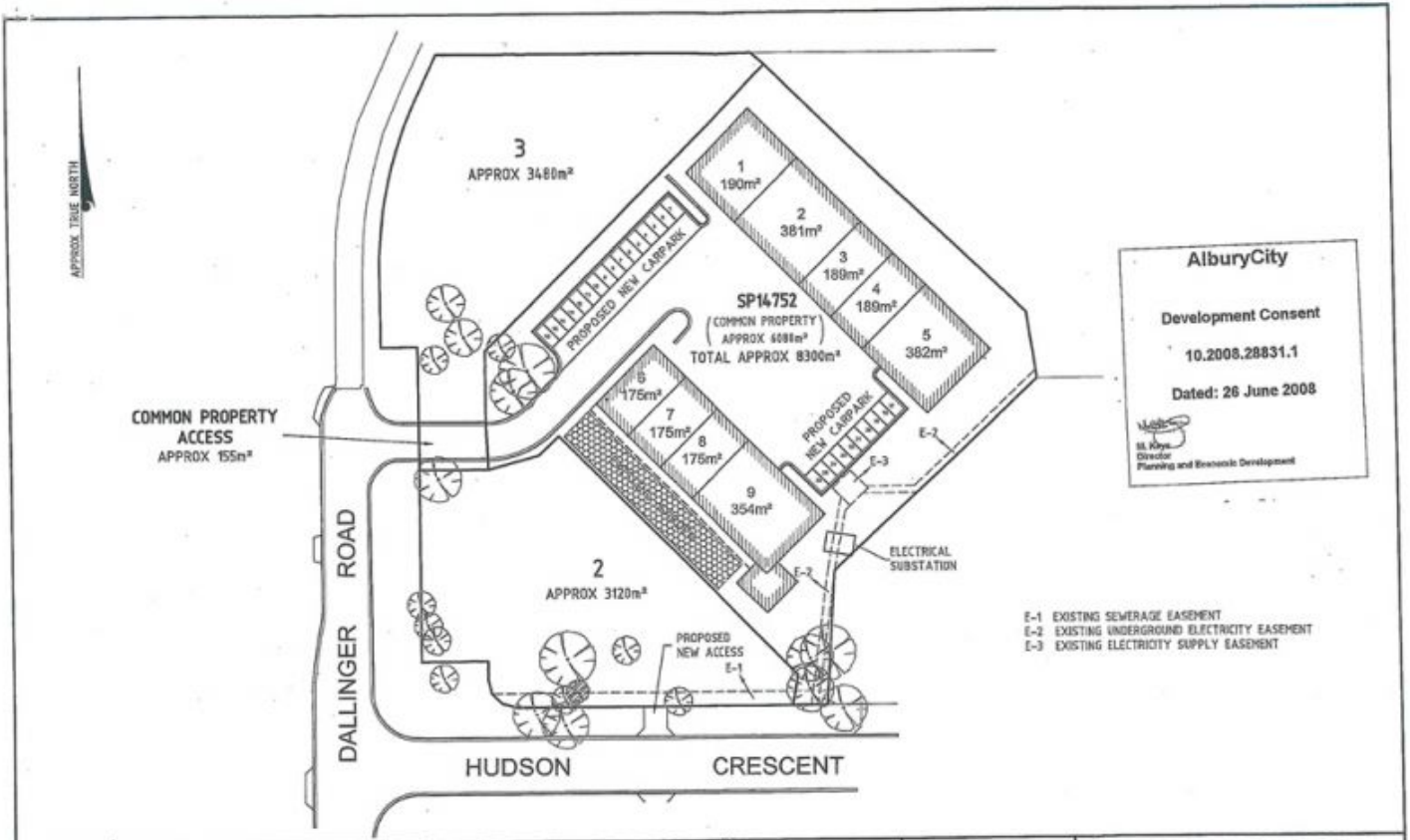

A3/10 Hudson Crescent Lavington NSW

- Area of 175 sqm (approx.)
- Currently leased
- Periodical tenancy
- Current rent \$11,250 per annum plus GST
- N.B. Suitable for owner / occupier

Building Size : 175 sqm
View : <https://www.dixoncre.au/sale/nsw/murra-y-region/lavington/commercial/industrial/5851246>



NOTE:
Areas, dimensions and lot layout are approximate only and are subject to final survey, council approval and registration of the Plan of Subdivision at the Titles Office

edm
EDM Group
PLANNERS SURVEYORS & ENGINEERS
COPYRIGHT
THIS DOCUMENT REMAINS THE PROPERTY OF EDM GROUP AND IS ONLY TO BE USED FOR ITS INTENDED PURPOSE IN ACCORDANCE WITH THE TERMS OF THAT AGREEMENT.
UNAUTHORIZED USE OF THIS DOCUMENT IN ANY FORM WHATSOEVER IS PROHIBITED.
© EDM Group

EDM Group
PLANNERS SURVEYORS & ENGINEERS
OFFICES 99 HUME ST
PO Box 317, WODONGA 3689
Ph (02) 6024 2266
Fax (02) 6056 2392
EDM Group Pty Ltd
www.edmgroup.com.au

DESIGN RESPONSE	
LOT 11 DP837414 AND SP14752 HUDSON CRESCENT LAVINGTON 2640	
Drawing No. 080024-ODP-8	Date 06/05/08
Scale 1:750	Sheet 1 of 1
Printed Sheet A3	