

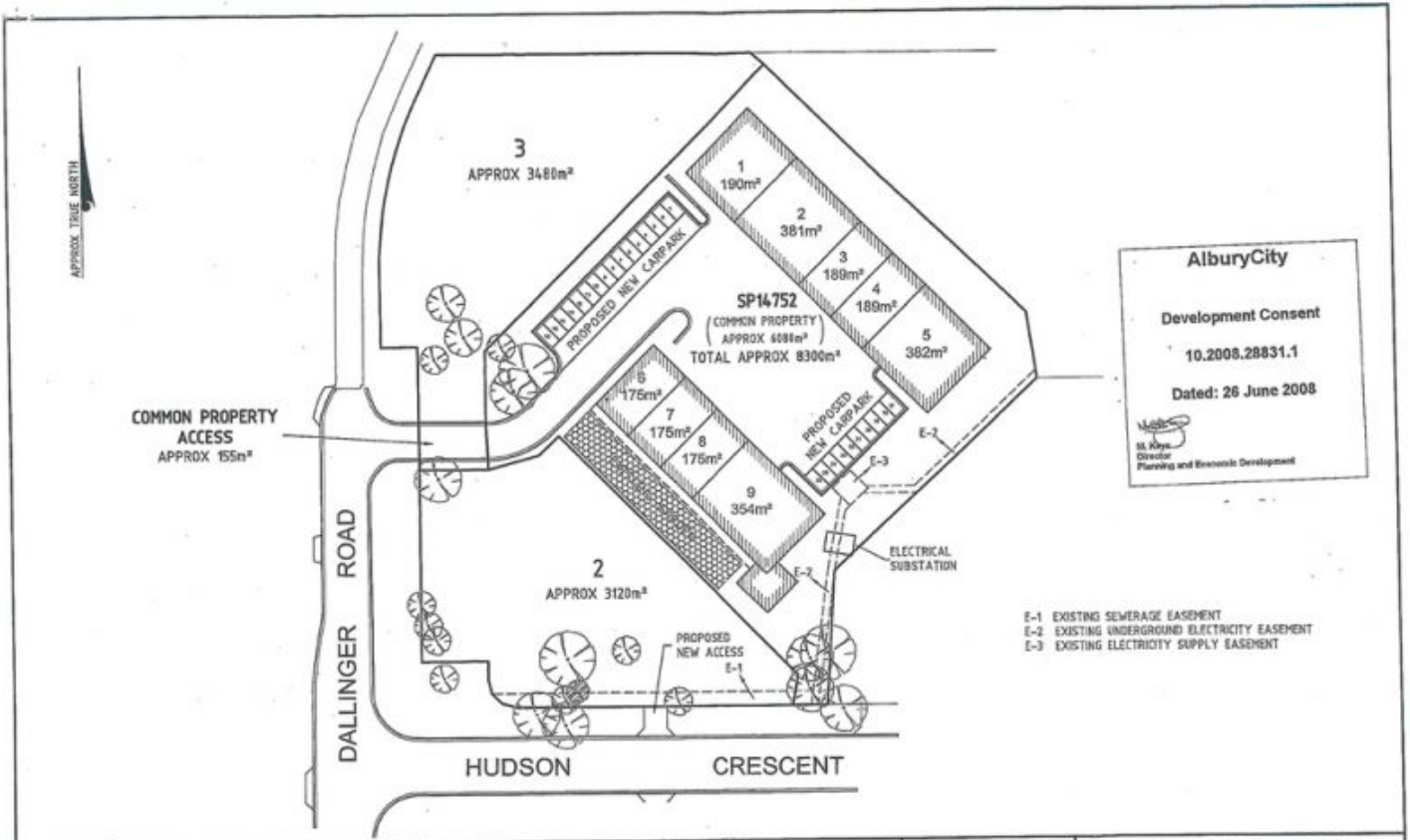

A1/10 Hudson Crescent Lavington NSW

- Comprising approx. 175m²
 - Leased to Pixie Ice Cream Pty Ltd
 - Three year lease commenced 1st June 2010
 - Current rent \$11,139.48 per annum
- N.B. Suitable for owner / occupier

Building Size : 175 sqm
View : <https://www.dixoncre.au/sale/nsw/murra-y-region/lavington/commercial/industrial/5851244>



AlburyCity
 Development Consent
 10.2008.28831.1
 Dated: 26 June 2008
 M. Kope
 Director
 Planning and Economic Development

E-1 EXISTING SEWERAGE EASEMENT
 E-2 EXISTING UNDERGROUND ELECTRICITY EASEMENT
 E-3 EXISTING ELECTRICITY SUPPLY EASEMENT

NOTE:
 Areas, dimensions and lot layout are approximate only and are subject to final survey, council approval and registration of the Plan of Subdivision at the Titles Office

edm
 Copyright
 This document remains the property of EDM Group and is only to be used for its intended purpose in accordance with the terms of that agreement. Unauthorised use of this document in any form whatsoever is prohibited.
 © EDM Group

EDM Group
 PLANNERS SURVEYORS & ENGINEERS
 OFFICES 99 HUME ST
 PO Box 317, WODONGA 3689
 Ph (02) 6024 2266
 Fax (02) 6056 2392
 EDM Group Pty Ltd
 www.edmgroup.com.au

DESIGN RESPONSE
 LOT 11 DP837414 AND SP14752
 HUDSON CRESCENT
 LAVINGTON 2640
 Drawing No. 080024-ODP-8 Date 06/05/08
 Scale 1:750
 SHEET 1 OF 1
 A3